



## CARBON STEEL VALVES

### GENEBRE PART: 2036 1PCE REDUCED BORE FLANGED BALL VALVE



#### SPECIFICATIONS

1	Material Carbon steel to DIN 37
2	Extended ends according to DIN 2501
3	Max working pressure 16/40 BAR (See PxT chart below)
4	Max Temperature -25°C to + 180°C
5	Reduced bore
6	Bi-directional flow
7	Graphited PTFE seats & PTFE seals
8	Maintenance free

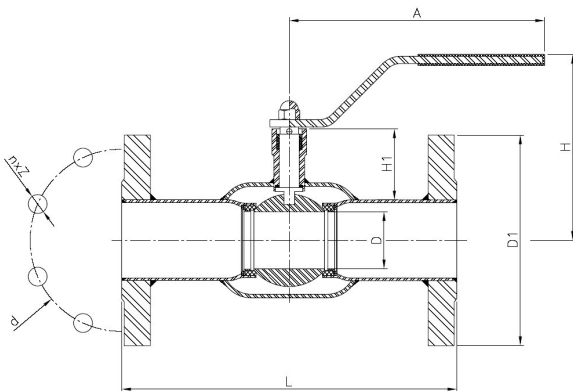

#### DIMENSIONS

AVOL REF	SIZE mm	PN BAR	A mm	L mm	H mm	D mm	Wt Kg
2036 04	1/2"	40	120	130	100	65	1.80
2036 05	3/4"	40	120	150	100	75	2.40
2036 06	1"	40	150	160	105	85	2.90
2036 07	1 1/4"	40	150	180	105	100	4.70
2036 08	1 1/2"	40	190	200	125	110	5.40
2036 09	2"	40	190	230	130	125	7.20
2036 10	2 1/2"	16	280	270	180	145	9.70
2036 11	3"	16	280	280	190	160	11.50
2036 12	4"	16	280	300	220	180	16.80
2036 13	5"	16	420	325	245	210	23.60
2036 14	6"	16	550	350	265	240	32.00
2036 16	8"	16	Gear	400	Gear	295	58.00
2036 18	10"	16	Gear	500	Gear	355	99.00
2036 20	12"	16	Gear	500	Gear	410	138.00

#### PRESSURE/ TEMPERATURE CHART

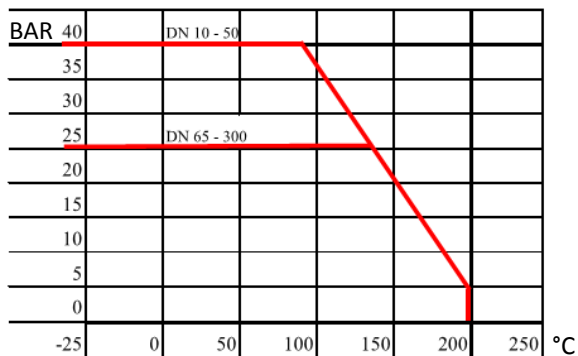

NOTE: Sizes 8" - 12" have gear operator (not shown)